

Mass Air Flow (MAF) Sensor

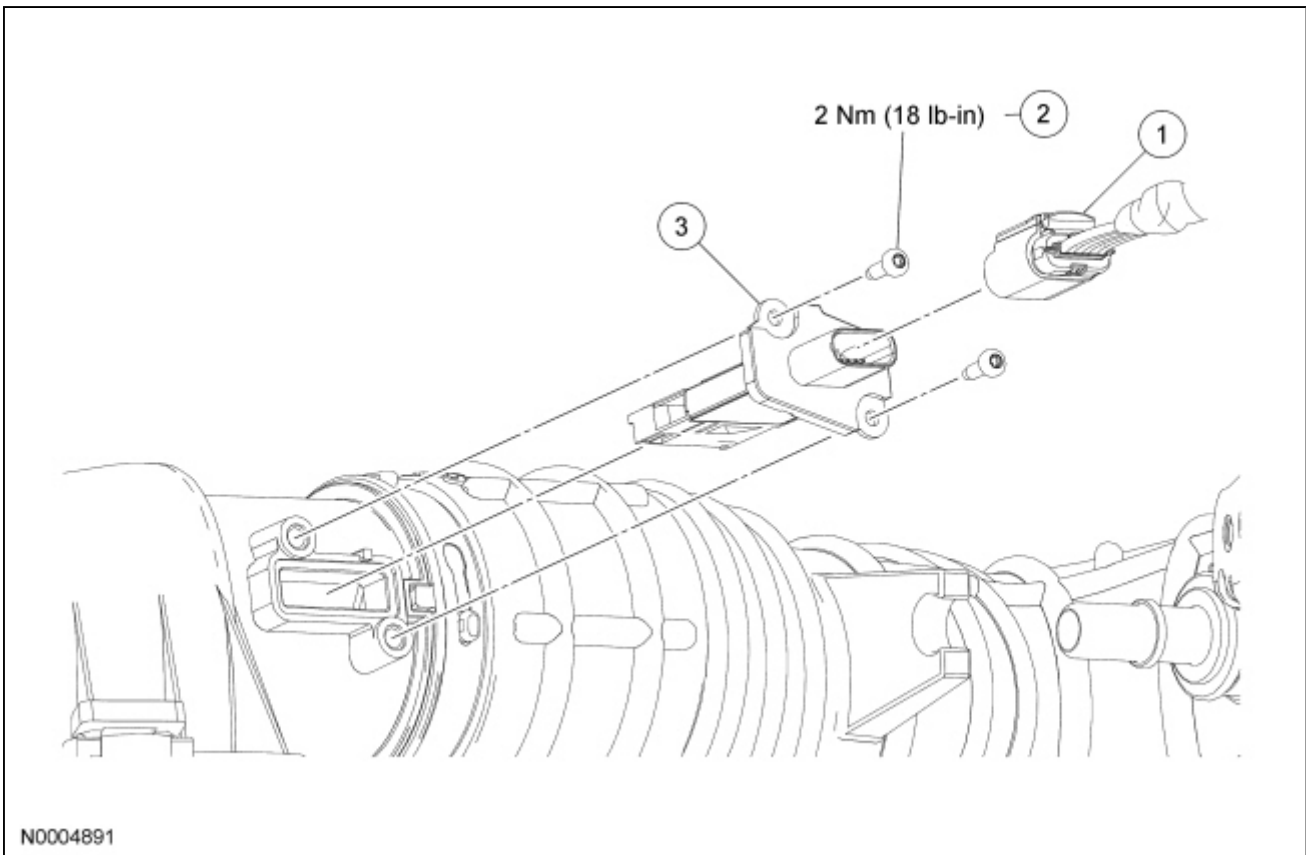

Item	Part Number	Description
1	14A464	Mass Air Flow (MAF) sensor electrical connector (part of 12B637)
2	W709287	MAF sensor screw (2 required)
3	12B579	MAF sensor

Removal and Installation

1. Disconnect the Mass Air Flow (MAF) sensor electrical connector.
2. Remove the 2 screws and the [MAF](#) sensor.
 - To install, tighten to 2 Nm (18 lb-in).
3. To install, reverse the removal procedure.

